

Lon: -117°15'41.13"W

Lat: 32°59'36.25N

# SENIOR LIVING CAMPUS



RIDEOUT HEALTH

SENIOR LIVING

**Fremont - Rideout Health Group  
Senior Living Campus  
1240 - 1260 Williams Way  
Yuba City, CA 95991**

**April 26, 2013    Revised: September 17, 2013**



**FONTS**

Foundry Old Style Medium

ABCDEFGHIJKLMNOPQRSTUVWXYZ  
 abcdefghijklmnopqrstuvwxyz

Foundry Old Style Book

ABCDEFGHIJKLMNOPQRSTUVWXYZ  
 abcdefghijklmnopqrstuvwxyz

Foundry Old Style Bold

ABCDEFGHIJKLMNOPQRSTUVWXYZ  
 abcdefghijklmnopqrstuvwxyz

Frutiger Regular

ABCDEFGHIJKLMNOPQRSTUVWXYZ  
 abcdefghijklmnopqrstuvwxyz

Frutiger Bold

ABCDEFGHIJKLMNOPQRSTUVWXYZ  
 abcdefghijklmnopqrstuvwxyz

**VENEERS**



ELDORADO STONE®  
 BLUFFSTONE MINERET®



TOP CAP  
 MT. MARRIAH  
 [A & A Stepping Stone Manufacturing, Inc.  
 10291 Ophir Road, Newcastle, CA 95901  
 (530) 885-7481]

MORTAR  
 BASALITE TYPE S 225 (GRAY)

THE SANS BOLD

ABCDEFGHIJKLMNOPQRSTUVWXYZ  
 abcdefghijklmnopqrstuvwxyz  
 1234567890

THE SANS ITALIC

ABCDEFGHIJKLMNOPQRSTUVWXYZ  
 abcdefghijklmnopqrstuvwxyz  
 1234567890

**SYMBOLS**

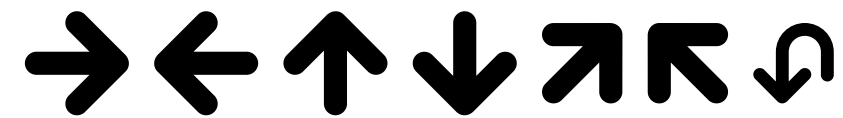

**FINISHES & VINYLs**



PAINTED TO MATCH PMS 3025C BLUE/GREEN (SATIN)



PAINTED TO MATCH PMS 186C RED (SATIN)  
 (3M 3630-53 CARDINAL RED - TRANSLUCENT)  
 (3M 3650-53 CARDINAL RED - OPAQUE)



PAINTED MATTHEWS BRUSHED ALUMINUM (SATIN)

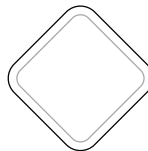

PAINTED SATIN WHITE  
 (3M 3630-20 WHITE - TRANSLUCENT)  
 (3M 7725-10 WHITE - OPAQUE)  
 (3M 680-10 WHITE - REFLECTIVE)



MATTHEWS PAINT MP 28448  
 UMBRA GREY METALLIC LRV 31.5 (SATIN)



SEATTLE • SAN DIEGO

MAIN OFFICE  
 380 STEVENS AVENUE #307  
 SOLANA BEACH, CA 92075

PHONE: 858.345.1542  
 FAX: 858.408.3203

CLIENT INFORMATION:  
 Fremont - Rideout  
 Health Group  
 Senior Living Campus  
 1240 - 1260 Williams Way  
 Yuba City, CA 95991

APPROVALS:  
 IG ACCOUNT MANAGER \_\_\_\_\_  
 IG PRODUCTION MANAGER \_\_\_\_\_  
 CLIENT APPROVAL \_\_\_\_\_

SALES REP:  
 Rebecca Redmon  
 DESIGNER:  
 R.Germar

REVISION DATES:  
 4 07-24-2013 RLG  
 5 08-08-2013 RLG  
 6 08-23-2013 RLG  
 7 09-10-2013 RLG  
 8 09-17-2013 RLG

VOLTAGE: 120V ☐  
 240V ☐

THIS ORIGINAL UNPUBLISHED DESIGN IS THE SOLE PROPERTY OF IMAGE GROUP. IT CANNOT BE REPRODUCED, COPIED OR EXHIBITED IN WHOLE OR PART, WITHOUT FIRST OBTAINING WRITTEN CONSENT FROM IMAGE GROUP. COLORS REPRESENTED IN THIS DRAWING ARE FOR PRESENTATION PURPOSES ONLY. THEY MAY NOT MATCH YOUR FINISHED PRODUCT PERFECTLY. COLOR CALL-OUTS ARE FOR REFERENCE PURPOSES ONLY.

PRIMARY ELECTRICAL TO SIGN LOCATIONS IS TO BE PROVIDED BY OTHERS. 20 AMP DEDICATED CIRCUIT(S) WITH NO SHARED NEUTRALS AND A GROUND RETURNING TO THE PANEL IS REQUIRED FOR ALL INSTALLATIONS. THIS SIGN IS INTENDED TO BE INSTALLED IN ACCORDANCE WITH THE REQUIREMENTS OF ARTICLE 600 OF THE NATIONAL ELECTRICAL CODE AND/OR OTHER APPLICABLE LOCAL CODES. THIS INCLUDES PROPER GROUNDING AND BONDING OF THE SIGN.

DATE  
 04-26-2013  
 DESIGN NO:  
 13-1071-08  
 PROJECT LOCATION:  
 Senior Living Campus  
 SIGN TYPE:

Project  
 Material  
 References



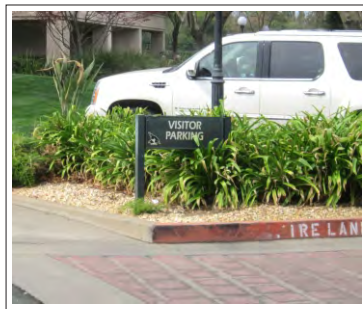

EXISTING POST & PANEL SIGN TO BE REMOVED & NOT REPLACED

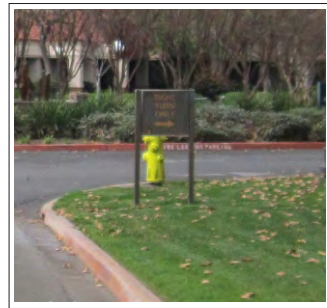

EXISTING POST & PANEL SIGN TO BE REMOVED & NOT REPLACED



EXISTING POST & PANEL SIGN TO BE REMOVED & NOT REPLACED



EXISTING POST & PANEL SIGN TO BE REMOVED & REPLACED WITH SIGN TYPE C.2



EXISTING POST & PANEL SIGN TO BE REMOVED & NOT REPLACED



EXISTING CAST BRASS PLAQUE TO BE REMOVED & REPLACED WITH SIGN TYPE S.1



EXISTING CAST BRASS PLAQUE TO BE REMOVED & REPLACED WITH SIGN TYPE S.2

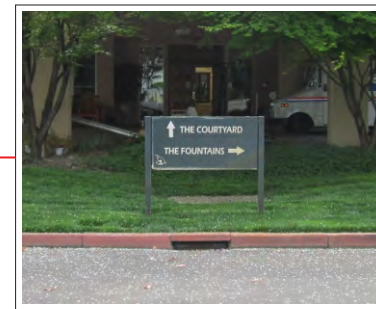

EXISTING POST & PANEL SIGN TO BE REMOVED & REPLACED WITH SIGN TYPE C.1



EXISTING GROUND SIGN TO BE REMOVED & REPLACED WITH SIGN TYPE D.1



EXISTING GROUND SIGN TO BE REMOVED & REPLACED WITH SIGN TYPE D.2

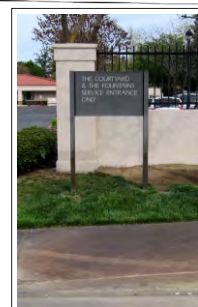
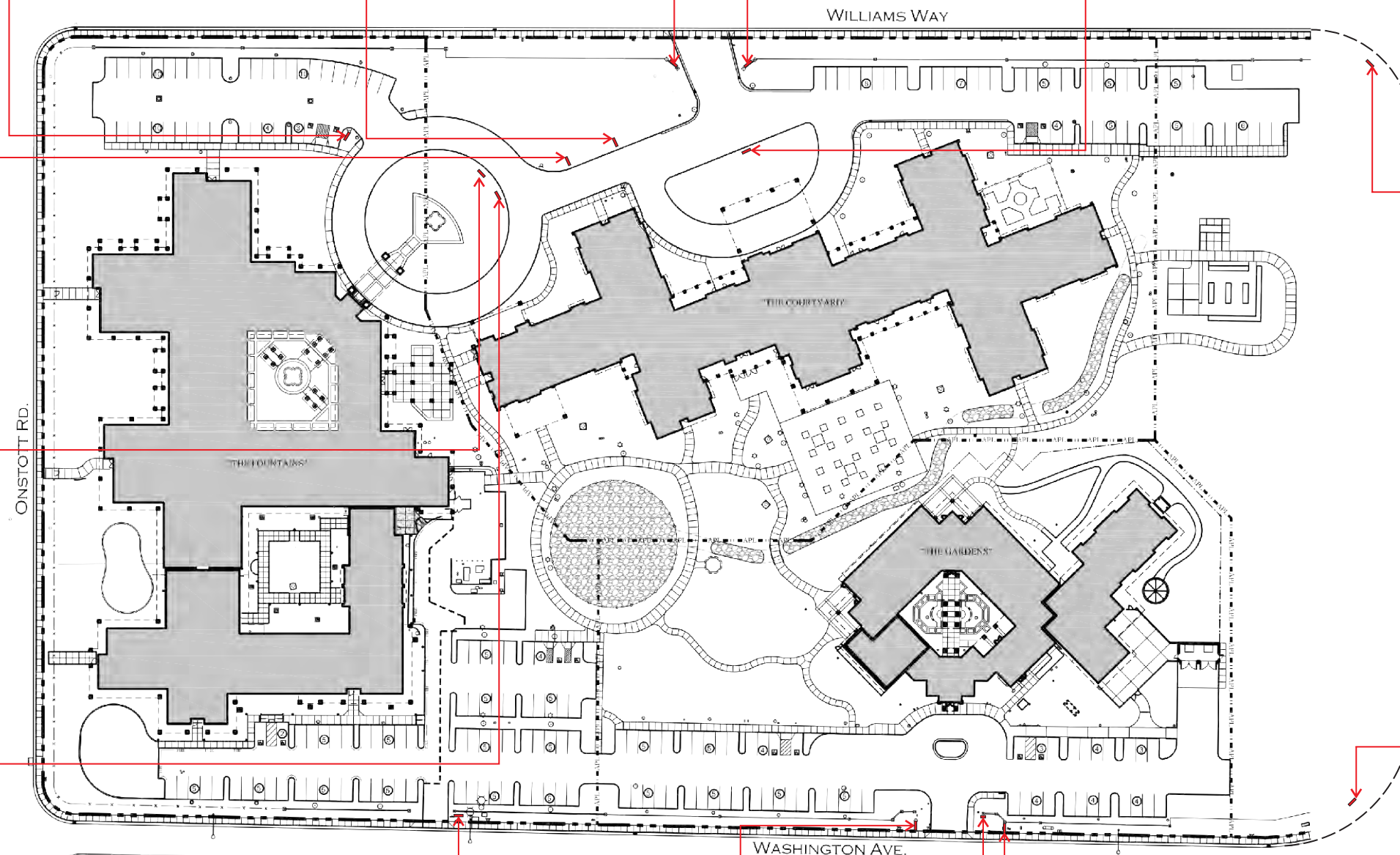

EXISTING POST & PANEL SIGN TO BE REMOVED & REPLACED WITH SIGN TYPE F.1

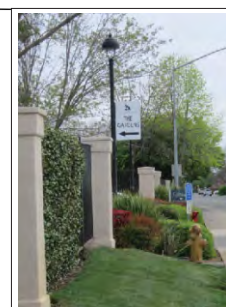

EXISTING POST MOUNTED SIGN TO BE REMOVED & NOT REPLACED

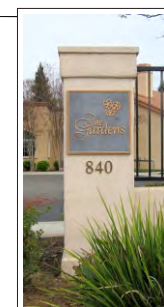

EXISTING CAST BRASS PLAQUE TO BE REMOVED & REPLACED WITH SIGN TYPE S.3



EXISTING GROUND SIGN TO BE REMOVED & REPLACED WITH SIGN TYPE E.1

SITE PLAN (SIGN REMOVAL)

SCALE: AS NOTED

0 20 40 80



CLIENT INFORMATION:

**Fremont - Rideout  
Health Group  
Senior Living Campus**  
1240 - 1260 Williams Way  
Yuba City, CA 95991

APPROVALS:

IG ACCOUNT MANAGER \_\_\_\_\_

IG PRODUCTION MANAGER \_\_\_\_\_

CLIENT APPROVAL \_\_\_\_\_

SALES REP:

**Rebecca Redmon**

DESIGNER:

**R.Germar**

REVISION DATES:

**4 07-24-2013 RLG**

**5 08-08-2013 RLG**

**6 08-23-2013 RLG**

**7 09-10-2013 RLG**

**8 09-17-2013 RLG**

VOLTAGE:

☐ 120V

☐ 240V

THIS ORIGINAL UNPUBLISHED DESIGN IS THE SOLE PROPERTY OF IMAGE GROUP. IT CANNOT BE REPRODUCED, COPIED OR EXHIBITED IN WHOLE OR PART, WITHOUT FIRST OBTAINING WRITTEN CONSENT FROM IMAGE GROUP. COLORS REPRESENTED IN THIS DRAWING ARE FOR PRESENTATION PURPOSES ONLY. THEY MAY NOT MATCH YOUR FINISHED PRODUCT PERFECTLY. COLOR CALL-OUTS ARE FOR REFERENCE PURPOSES ONLY.

PRIMARY ELECTRICAL TO SIGN LOCATIONS IS TO BE PROVIDED BY OTHERS. 20 AMP DEDICATED CIRCUIT(S) WITH NO SHARED NEUTRALS AND A GROUND RETURNING TO THE PANEL IS REQUIRED FOR ALL INSTALLATIONS. THIS SIGN IS INTENDED TO BE INSTALLED IN ACCORDANCE WITH THE REQUIREMENTS OF ARTICLE 600 OF THE NATIONAL ELECTRICAL CODE AND/OR OTHER APPLICABLE LOCAL CODES. THIS INCLUDES PROPER GROUNDING AND BONDING OF THE SIGN.

DATE

**04-26-2013**

DESIGN NO:

**13-1071-08**

PROJECT LOCATION:

**Senior Living Campus**

SIGN TYPE:

**Site Plan of  
Existing Signage**



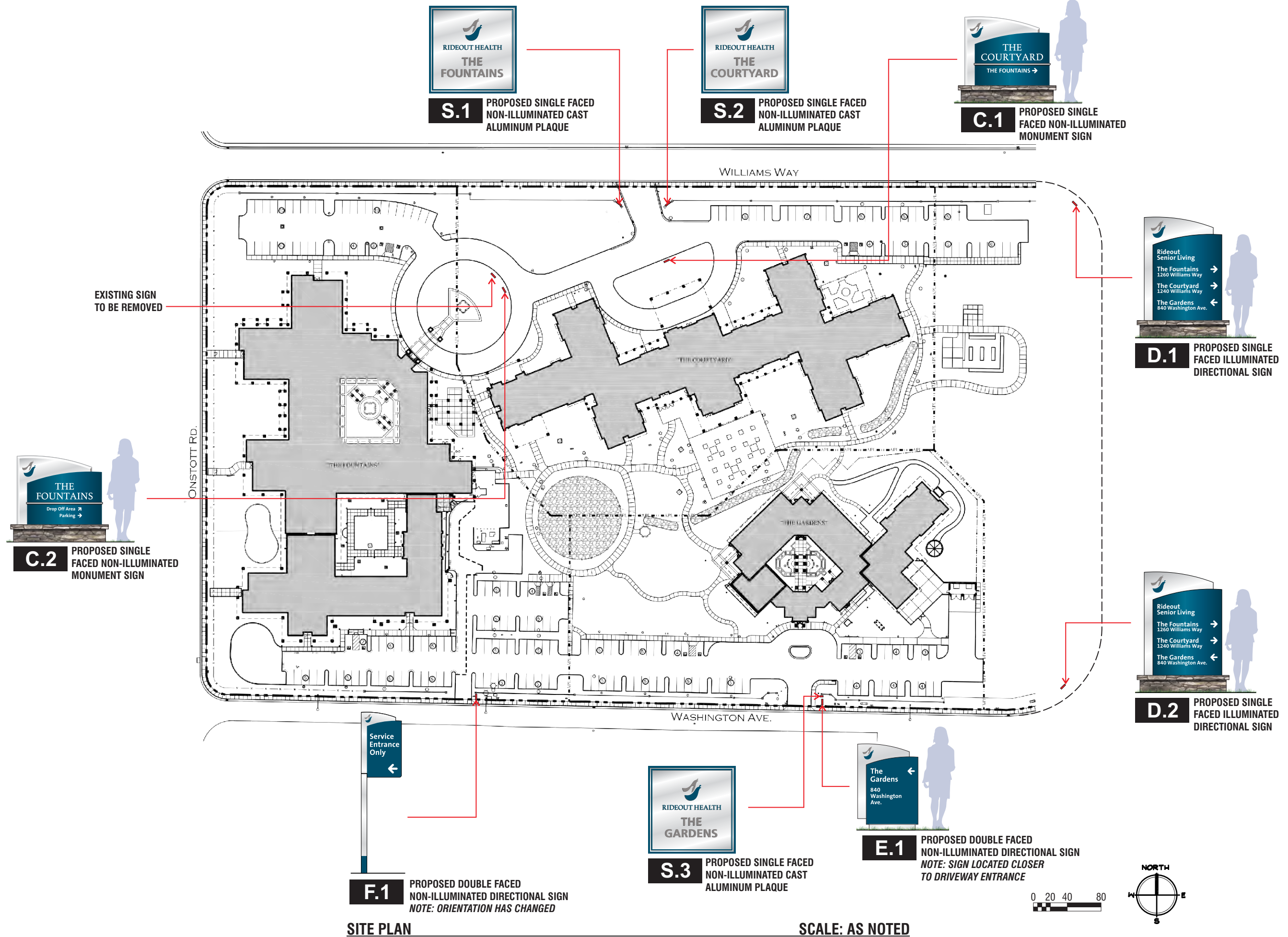

**CLIENT INFORMATION:**  
**Fremont - Rideout Health Group**  
**Senior Living Campus**  
1240 - 1260 Williams Way  
Yuba City, CA 95991

**APPROVALS:**  
IG ACCOUNT MANAGER \_\_\_\_\_  
IG PRODUCTION MANAGER \_\_\_\_\_  
CLIENT APPROVAL \_\_\_\_\_

**SALES REP:**  
**Rebecca Redmon**  
**DESIGNER:**  
**R.Germar**

**REVISION DATES:**  
4 07-24-2013 RLG  
5 08-08-2013 RLG  
6 08-23-2013 RLG  
7 09-10-2013 RLG  
8 09-17-2013 RLG

**VOLTAGE:** 120V ☐  
240V ☐

THIS ORIGINAL UNPUBLISHED DESIGN IS THE SOLE PROPERTY OF IMAGE GROUP. IT CANNOT BE REPRODUCED, COPIED OR EXHIBITED IN WHOLE OR PART, WITHOUT FIRST OBTAINING WRITTEN CONSENT FROM IMAGE GROUP. COLORS REPRESENTED IN THIS DRAWING ARE FOR PRESENTATION PURPOSES ONLY. THEY MAY NOT MATCH YOUR FINISHED PRODUCT PERFECTLY. COLOR CALL-OUTS ARE FOR REFERENCE PURPOSES ONLY.

PRIMARY ELECTRICAL TO SIGN LOCATIONS IS TO BE PROVIDED BY OTHERS. 20 AMP DEDICATED CIRCUIT(S) WITH NO SHARED NEUTRALS AND A GROUND RETURNING TO THE PANEL IS REQUIRED FOR ALL INSTALLATIONS. THIS SIGN IS INTENDED TO BE INSTALLED IN ACCORDANCE WITH THE REQUIREMENTS OF ARTICLE 600 OF THE NATIONAL ELECTRICAL CODE AND/OR OTHER APPLICABLE LOCAL CODES. THIS INCLUDES PROPER GROUNDING AND BONDING OF THE SIGN.

**DATE**  
04-26-2013  
**DESIGN NO:**  
13-1071-08  
**PROJECT LOCATION:**  
Senior Living Campus  
**SIGN TYPE:**  
**Site Plan of Proposed Signage**

CLIENT INFORMATION:

Fremont - Rideout  
Health Group  
Senior Living Campus  
1240 - 1260 Williams Way  
Yuba City, CA 95991

APPROVALS:

IG ACCOUNT MANAGER \_\_\_\_\_

IG PRODUCTION MANAGER \_\_\_\_\_

CLIENT APPROVAL \_\_\_\_\_

SALES REP:

Rebecca Redmon

DESIGNER:

R.Germar

REVISION DATES:

4 07-24-2013 RLG

5 08-08-2013 RLG

6 08-23-2013 RLG

7 09-10-2013 RLG

8 09-17-2013 RLG

VOLTAGE: 120V ☐  
240V ☐

THIS ORIGINAL UNPUBLISHED DESIGN IS THE SOLE PROPERTY OF IMAGE GROUP. IT CANNOT BE REPRODUCED, COPIED OR EXHIBITED IN WHOLE OR PART, WITHOUT FIRST OBTAINING WRITTEN CONSENT FROM IMAGE GROUP. COLORS REPRESENTED IN THIS DRAWING ARE FOR PRESENTATION PURPOSES ONLY. THEY MAY NOT MATCH YOUR FINISHED PRODUCT PERFECTLY. COLOR CALL-OUTS ARE FOR REFERENCE PURPOSES ONLY.

PRIMARY ELECTRICAL TO SIGN LOCATIONS IS TO BE PROVIDED BY OTHERS. 20 AMP DEDICATED CIRCUIT(S) WITH NO SHARED NEUTRALS AND A GROUND RETURNING TO THE PANEL IS REQUIRED FOR ALL INSTALLATIONS. THIS SIGN IS INTENDED TO BE INSTALLED IN ACCORDANCE WITH THE REQUIREMENTS OF ARTICLE 600 OF THE NATIONAL ELECTRICAL CODE AND/OR OTHER APPLICABLE LOCAL CODES. THIS INCLUDES PROPER GROUNDING AND BONDING OF THE SIGN.

DATE

04-26-2013

DESIGN NO:

13-1071-08

PROJECT LOCATION:

Senior Living Campus

SIGN TYPE:

Sign Type C  
S/F Monument  
Sign

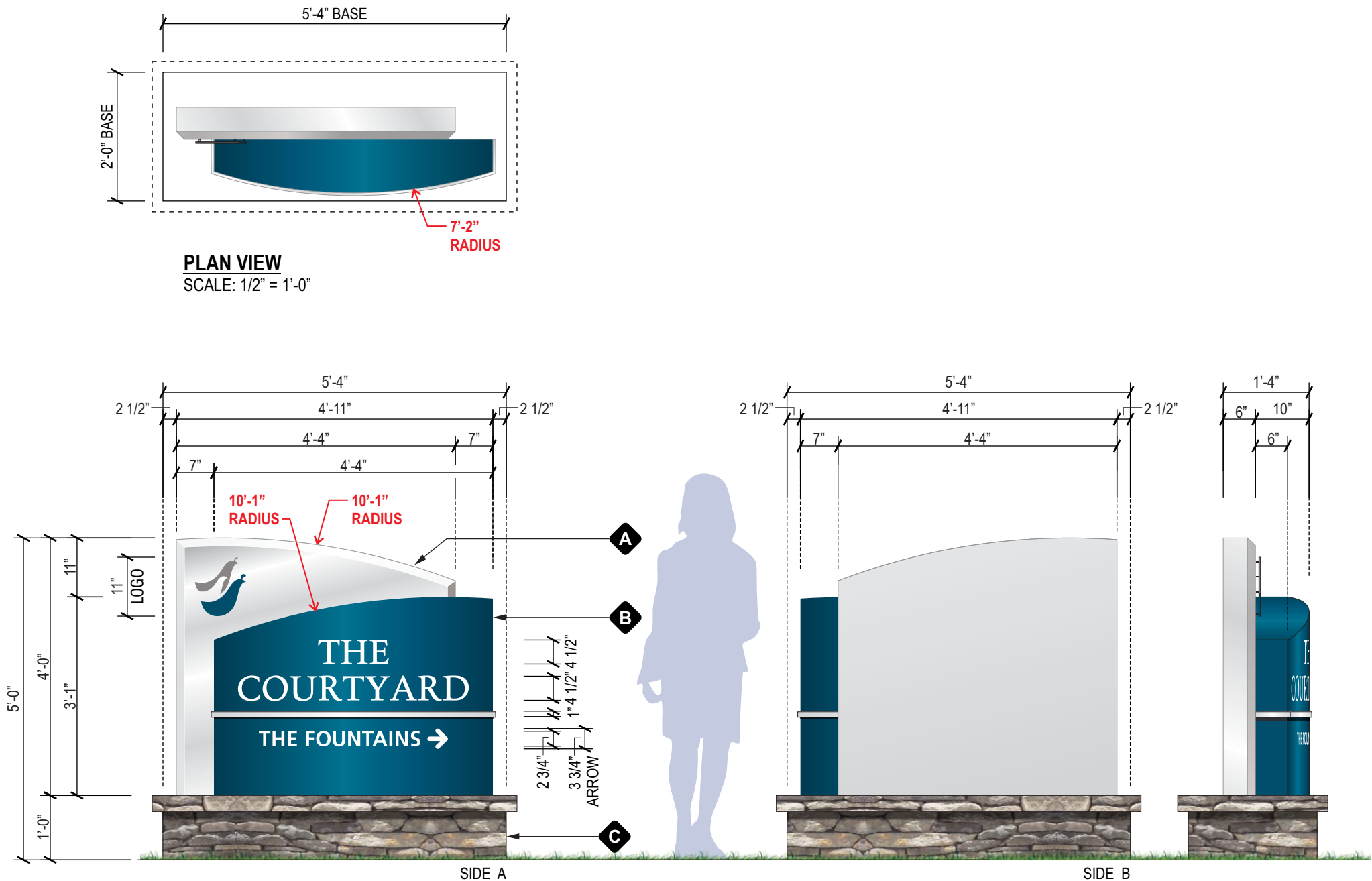

A

BACK CABINET

CABINET MATERIAL: .125" THICK ALUMINUM OVER 1 1/2" X 1 1/2" ALUMINUM ANGLE FRAME. FACE RETURNS OF CABINET TO BE BEVELED.

CABINET FINISH: PAINTED MATTHEWS BRUSHED ALUMINUM (SATIN)

CABINET DEPTH: 6"

FACE MATERIAL: .125" THICK ALUMINUM

FACE FINISH: PAINTED MATTHEWS BRUSHED ALUMINUM (SATIN)

GRAPHIC SPECS: ROUTED 1/4" THICK ALUMINUM PLATE LOGO, SPACED OFF 1/2" FROM CABINET FACE.

GRAPHIC FINISH: FACES & EDGES PAINTED TO MATCH PMS 3025C BLUE/GREEN (SATIN) & MATTHEWS PAINT MP 28448 UMBRA GREY METALLIC LRV 31.5 (SATIN)

ILLUMINATION: NONE

INTERNAL SUPPORT MATERIAL: PER ENGINEERING

INSTALL METHOD: CABINET TO HAVE INTERNAL FABRICATED SADDLE TO ACCEPT STEEL TUBE SUPPORT. CABINET TO BE THRU-BOLTED THRU SADDLE INTO STEEL TUBE SUPPORTS. ALSO BOLTED TO STEEL FRAME OF BASE.

B

FRONT CABINET

CABINET MATERIAL: .125" THICK ALUMINUM OVER 1 1/2" X 1 1/2" ALUMINUM ANGLE FRAME.

CABINET FINISH: PAINTED TO MATCH PMS 3025C BLUE/GREEN (SATIN)

CABINET DEPTH: 6" @ THINNEST - 10" @ DEEPEST

FACE MATERIAL: ROLLED .125" THICK ALUMINUM

FACE FINISH: PAINTED TO MATCH PMS 3025C BLUE/GREEN (SATIN)

GRAPHIC SPECS: ROUTED OUT OF FACE AND BACKED W/ 3/16" THICK WHITE #7328 ACRYLIC

ACCENT LINE MATERIAL: 1/2" THICK X 1" WIDE ALUMINUM PLATE - ROLLED TO MATCH RADIUS OF FACE & TO WRAP RETURNS OF CABINET

ACCENT FINISH: PAINTED MATTHEWS BRUSHED ALUMINUM (SATIN)

ILLUMINATION: NONE

INTERNAL SUPPORT MATERIAL: PER ENGINEERING

INSTALL METHOD: CABINET TO BE BOLTED TO BACK CABINET.

C

BASE

BASE MATERIAL: STONE VENEER & DUROCK CLADDING OVER 1 1/2" X 1 1/2" STEEL ANGLE FRAME

VENEER SPECS: EL DORADO STONE - BLUFFSTONE MINERET

TOP CAP: MT. MARRIAH

MORTAR: BASALITE TYPE S 225 (GRAY)

.125" THK. ROUTED ALUM.  
FACE. ALL SEAMS FILLED &  
GROUND SMOOTH

ROUTED OUT GRAPHICS  
BACKED UP WITH 3/16" THK.  
WHITE #7328 ACRYLIC

3/16" THK. CLEAR ARYLIC STUD  
MOUNTED CARRIER PANEL

ENLARGED DETAIL AT BACKED-UP GRAPHICS  
NO SCALE

C.1 (SIGN TYPE C) S/F NON-ILLUMINATED MONUMENT SIGN

SCALE: 1/2" = 1'-0"

QTY - 1



CLIENT INFORMATION:

Fremont - Rideout  
Health Group  
Senior Living Campus  
1240 - 1260 Williams Way  
Yuba City, CA 95991

APPROVALS:

IG ACCOUNT MANAGER \_\_\_\_\_

IG PRODUCTION MANAGER \_\_\_\_\_

CLIENT APPROVAL \_\_\_\_\_

SALES REP:

Rebecca Redmon

DESIGNER:

R.Germar

REVISION DATES:

4 07-24-2013 RLG

5 08-08-2013 RLG

6 08-23-2013 RLG

7 09-10-2013 RLG

8 09-17-2013 RLG

VOLTAGE: 120V ☐  
240V ☐

THIS ORIGINAL UNPUBLISHED DESIGN IS THE SOLE PROPERTY OF IMAGE GROUP. IT CANNOT BE REPRODUCED, COPIED OR EXHIBITED IN WHOLE OR PART, WITHOUT FIRST OBTAINING WRITTEN CONSENT FROM IMAGE GROUP. COLORS REPRESENTED IN THIS DRAWING ARE FOR PRESENTATION PURPOSES ONLY. THEY MAY NOT MATCH YOUR FINISHED PRODUCT PERFECTLY. COLOR CALL-OUTS ARE FOR REFERENCE PURPOSES ONLY.

PRIMARY ELECTRICAL TO SIGN LOCATIONS IS TO BE PROVIDED BY OTHERS. 20 AMP DEDICATED CIRCUIT(S) WITH NO SHARED NEUTRALS AND A GROUND RETURNING TO THE PANEL IS REQUIRED FOR ALL INSTALLATIONS. THIS SIGN IS INTENDED TO BE INSTALLED IN ACCORDANCE WITH THE REQUIREMENTS OF ARTICLE 600 OF THE NATIONAL ELECTRICAL CODE AND/OR OTHER APPLICABLE LOCAL CODES. THIS INCLUDES PROPER GROUNDING AND BONDING OF THE SIGN.

DATE

04-26-2013

DESIGN NO:

13-1071-08

PROJECT LOCATION:

Senior Living Campus

SIGN TYPE:

Sign Type C  
S/F Monument  
Sign

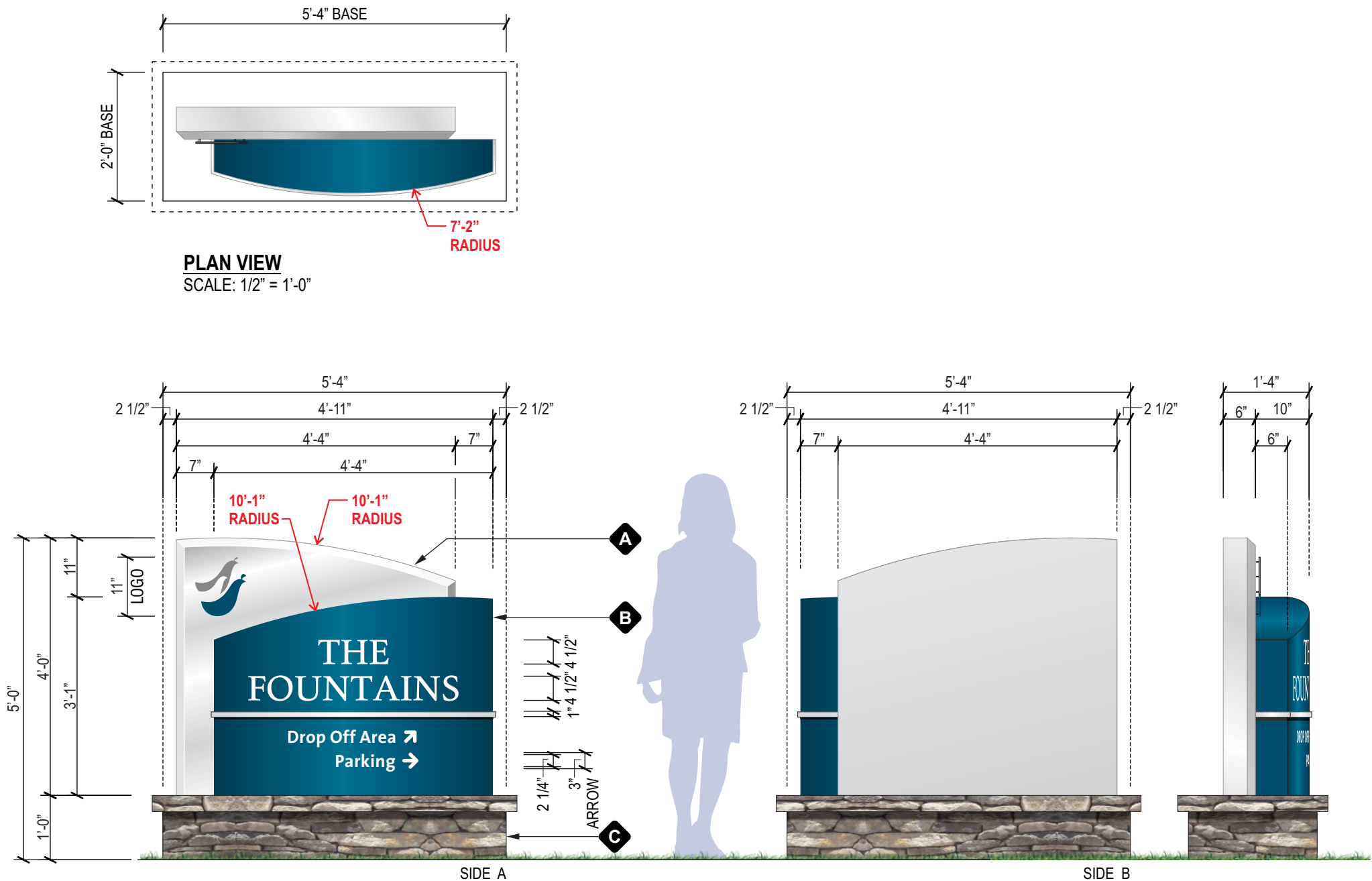

**C.2 (SIGN TYPE C) S/F NON-ILLUMINATED MONUMENT SIGN**  
SCALE: 1/2" = 1'-0" QTY - 1

**SIGN SPECIFICATIONS**

**A**

**BACK CABINET**

**CABINET MATERIAL:** .125" THICK ALUMINUM OVER 1 1/2" X 1 1/2" ALUMINUM ANGLE FRAME. FACE RETURNS OF CABINET TO BE BEVELED.  
**CABINET FINISH:** PAINTED MATTHEWS BRUSHED ALUMINUM (SATIN)  
**CABINET DEPTH:** 6"  
**FACE MATERIAL:** .125" THICK ALUMINUM  
**FACE FINISH:** PAINTED MATTHEWS BRUSHED ALUMINUM (SATIN)  
**GRAPHIC SPECS:** ROUTED 1/4" THICK ALUMINUM PLATE LOGO, SPACED OFF 1/2" FROM CABINET FACE.  
**GRAPHIC FINISH:** FACES & EDGES PAINTED TO MATCH PMS 3025C BLUE/GREEN (SATIN) & MATTHEWS PAINT MP 28448 UMBRA GREY METALLIC LRV 31.5 (SATIN)  
**ILLUMINATION:** NONE  
**INTERNAL SUPPORT MATERIAL:** PER ENGINEERING  
**INSTALL METHOD:** CABINET TO HAVE INTERNAL FABRICATED SADDLE TO ACCEPT STEEL TUBE SUPPORT. CABINET TO BE THRU-BOLTED THRU SADDLE INTO STEEL TUBE SUPPORTS. ALSO BOLTED TO STEEL FRAME OF BASE.

**B**

**FRONT CABINET**

**CABINET MATERIAL:** .125" THICK ALUMINUM OVER 1 1/2" X 1 1/2" ALUMINUM ANGLE FRAME.  
**CABINET FINISH:** PAINTED TO MATCH PMS 3025C BLUE/GREEN (SATIN)  
**CABINET DEPTH:** 6" @ THINNEST - 10" @ DEEPEST  
**FACE MATERIAL:** ROLLED .125" THICK ALUMINUM  
**FACE FINISH:** PAINTED TO MATCH PMS 3025C BLUE/GREEN (SATIN)  
**GRAPHIC SPECS:** ROUTED OUT OF FACE AND BACKED W/ 3/16" THICK WHITE #7328 ACRYLIC  
**ACCENT LINE MATERIAL:** 1/2" THICK X 1" WIDE ALUMINUM PLATE - ROLLED TO MATCH RADIUS OF FACE & TO WRAP RETURNS OF CABINET  
**ACCENT FINISH:** PAINTED MATTHEWS BRUSHED ALUMINUM (SATIN)  
**ILLUMINATION:** NONE  
**INTERNAL SUPPORT MATERIAL:** PER ENGINEERING  
**INSTALL METHOD:** CABINET TO BE BOLTED TO BACK CABINET.

**C**

**BASE**

**BASE MATERIAL:** STONE VENEER & DUROCK CLADDING OVER 1 1/2" X 1 1/2" STEEL ANGLE FRAME  
**VENEER SPECS:** EL DORADO STONE - BLUFFSTONE MINERET  
**TOP CAP:** MT. MARRIAH  
**MORTAR:** BASALITE TYPE S 225 (GRAY)

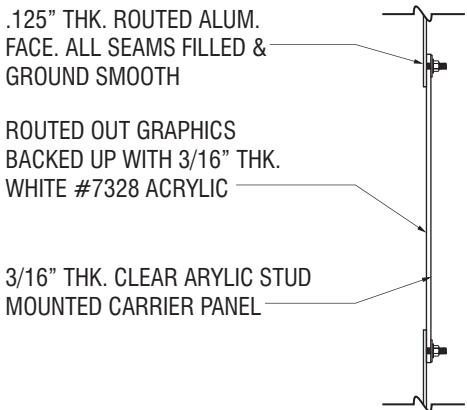

**ENLARGED DETAIL AT BACKED-UP GRAPHICS**  
NO SCALE

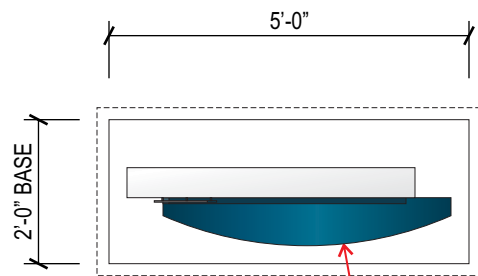

**PLAN VIEW**  
SCALE: 3/8" = 1'-0"

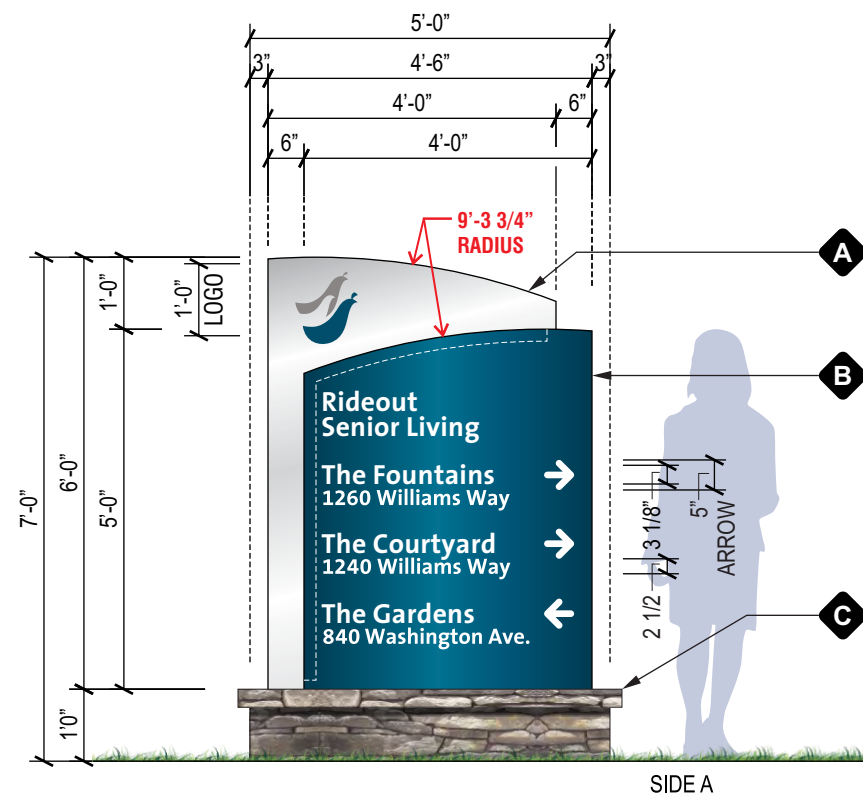

SIDE A

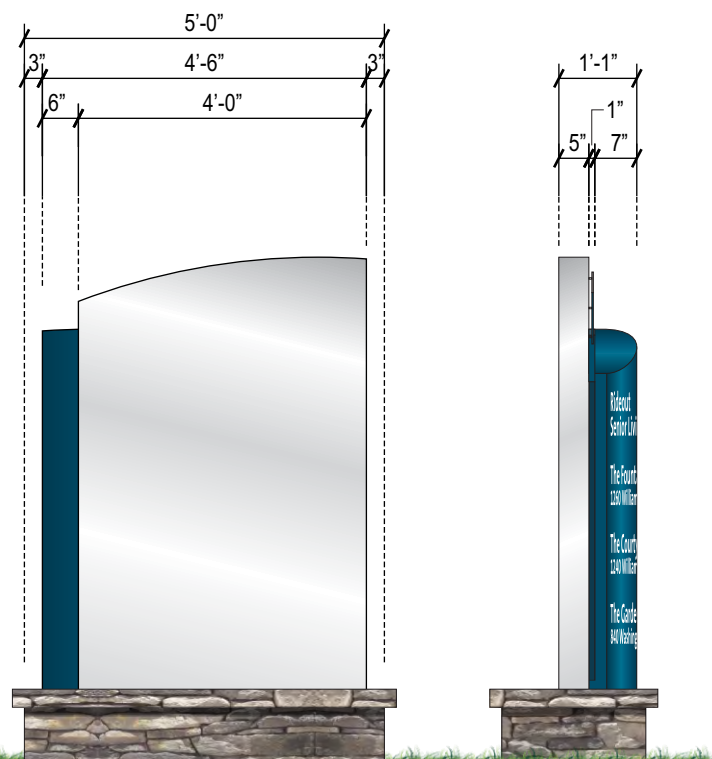

SIDE B

**SIDE VIEW**  
SCALE: 3/8" = 1'-0"

## SIGN SPECIFICATIONS

- A ACCENT FIN**  
**MATERIAL:** .125" THICK ALUMINUM OVER 1 1/2" X 1 1/2" ALUMINUM ANGLE FRAME.  
**FINISH:** PAINTED MATTHEWS BRUSHED ALUMINUM (SATIN).  
**FINISH DEPTH:** 5"  
**FACE MATERIAL:** .125" THICK ALUMINUM  
**FACE FINISH:** PAINTED MATTHEWS BRUSHED ALUMINUM (SATIN).  
**GRAPHIC SPECS:** ROUTED 1/4" THICK ALUMINUM PLATE LOGO SPACED OFF 1/2" FROM CABINET FACE - AREA BEHIND LOGO TO BE BACKED WITH 3/16" THICK #7328 WHITE ACRYLIC (WILL HAVE A HALO ILLUMINATION AT NIGHT).  
**GRAPHIC FINISH:** FACES & EDGES PAINTED TO MATCH PMS 3025C BLUE/GREEN (SATIN) & MATTHEWS PAINT MP 28448 UMBRA GREY METALLIC LRV 31.5 (SATIN).  
**ILLUMINATION:** WHITE LED'S.  
**INTERNAL SUPPORT MATERIAL:** PER ENGINEERING  
**INSTALL METHOD:** CABINET TO HAVE INTERNAL FABRICATED SADDLE TO ACCEPT STEEL TUBE SUPPORT. CABINET TO BE THRU-BOLTED THRU SADDLE INTO STEEL TUBE SUPPORTS. ALSO BOLTED TO STEEL FRAME OF BASE.

- B MAIN CABINET**  
**CABINET MATERIAL:** .125" THICK ALUMINUM OVER 1 1/2" X 1 1/2" ALUMINUM ANGLE FRAME. TO HAVE A 1" REVEAL WHERE FRONT AND BACK CABINETS MEET. REVEAL TO HOUSE WHITE LED'S. ILLUMINATION TO WASH ONTO ACCENT FIN.  
**CABINET FINISH:** PAINTED TO MATCH PMS 3025C BLUE/GREEN (SATIN).  
**CABINET DEPTH:** 3" @ THINNEST - 7" @ DEEPEST  
**FACE MATERIAL:** ROLLED .125" THICK ALUMINUM  
**FACE FINISH:** PAINTED TO MATCH PMS 3025C BLUE/GREEN (SATIN).  
**GRAPHIC SPECS:** ROUTED OUT OF FACE AND BACKED W/ 3/16" THICK WHITE #7328 ACRYLIC  
**INTERNAL ILLUMINATION:** WHITE LED'S  
**INTERNAL SUPPORT MATERIAL:** PER ENGINEERING  
**INSTALL METHOD:** CABINET TO BE BOLTED TO ACCENT FIN

- C BASE**  
**BASE:** STONE VENEER & DUROCK CLADDING OVER 1 1/2" X 1 1/2" STEEL ANGLE FRAME.  
**VENEER SPECS:** EL DORADO STONE - BLUFFSTONE MINERET  
**TOP CAP:** MT. MARRIAH  
**MORTAR:** BASALITE TYPE S 225 (GRAY)

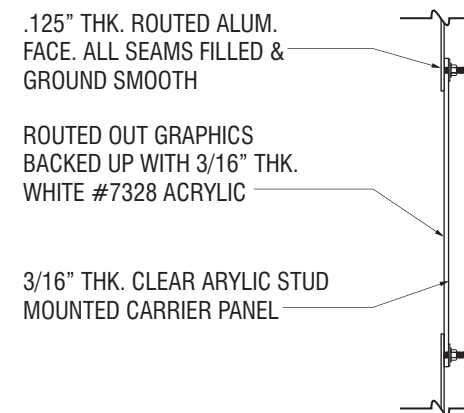

**ENLARGED DETAIL AT BACKED-UP GRAPHICS**  
NO SCALE

**D.1 D.2 (SIGN TYPE D) S/F INTERNALLY  
ILLUMINATED DIRECTIONAL SIGN**  
SCALE: 3/8" = 1'-0" **QTY - 2**

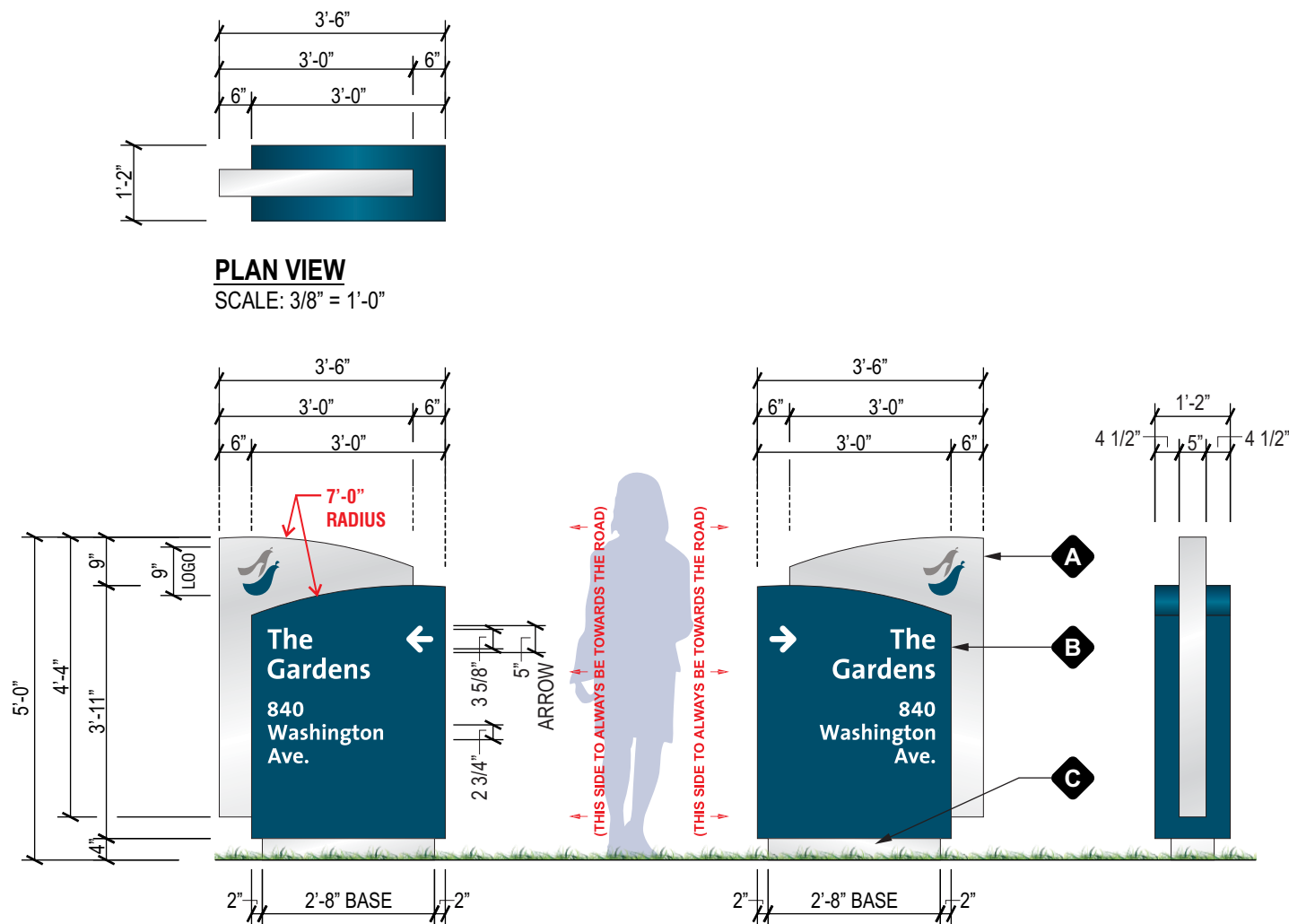

**E.1** (SIGN TYPE E) D/F  
**NON-ILLUMINATED DIRECTIONAL SIGN**  
SCALE: 3/8" = 1'-0" **QTY - 1**

**SIDE VIEW**  
SCALE: 3/8" = 1'-0"

## SIGN SPECIFICATIONS

- A ACCENT FIN**  
MATERIAL: .125" THICK ALUMINUM OVER 1 1/2" X 1 1/2" ALUMINUM ANGLE FRAME.  
FINISH: PAINTED MATTHEWS BRUSHED ALUMINUM (SATIN).  
FINISH DEPTH: 5"  
FACE MATERIAL: .125" THICK ALUMINUM  
FACE FINISH: PAINTED MATTHEWS BRUSHED ALUMINUM (SATIN).  
GRAPHIC SPECS: MASKED & PAINTED GRAPHICS  
GRAPHIC FINISH: PAINTED TO MATCH PMS 3025C BLUE/GREEN (SATIN) & MATTHEWS PAINT MP 28448 UMBRA GREY METALLIC LRV 31.5 (SATIN).  
INSTALL METHOD: CABINET TO HAVE INTERNAL FABRICATED SADDLE TO ACCEPT STEEL TUBE SUPPORT. CABINET TO BE THRU-BOLTED THRU SADDLE INTO STEEL TUBE SUPPORTS.

- B MAIN CABINET**  
CABINET MATERIAL: .125" THICK ALUMINUM OVER 1 1/2" X 1 1/2" ALUMINUM ANGLE FRAME.  
CABINET FINISH: PAINTED TO MATCH PMS 3025C BLUE/GREEN (SATIN).  
CABINET DEPTH: 1'-2"  
FACE MATERIAL: .125" THICK ALUMINUM  
FACE FINISH: PAINTED TO MATCH PMS 3025C BLUE/GREEN (SATIN).  
GRAPHIC SPECS: 3M 680-10 REFLECTIVE WHITE VINYL COPY.  
INTERNAL ILLUMINATION: NONE.  
INTERNAL SUPPORT MATERIAL: 3" X 3" STL TUBE (X1) - TO PROJECT BELOW SIGN TO MATCH REQ. FOOTING DEPTH.  
INSTALL METHOD: CABINET TO BE BOLTED TO ACCENT FIN.

- C BASE**  
BASE: 4" X 2" ALUMINUM CHANNEL.  
BASE FINISH: PAINTED MATTHEWS BRUSHED ALUMINUM (SATIN).  
INSTALL METHOD: THRU-BOLTED THRU BOTTOM OF MAIN CABINET FRAME. ENTIRE SIGN IS INSTALLED INTO A POURED CONCRETE FOOTER. MAIN SUPPORT IS DIRECTLY BURIED INTO AUGURED HOLE FILLED W/ CONCRETE.



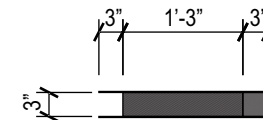
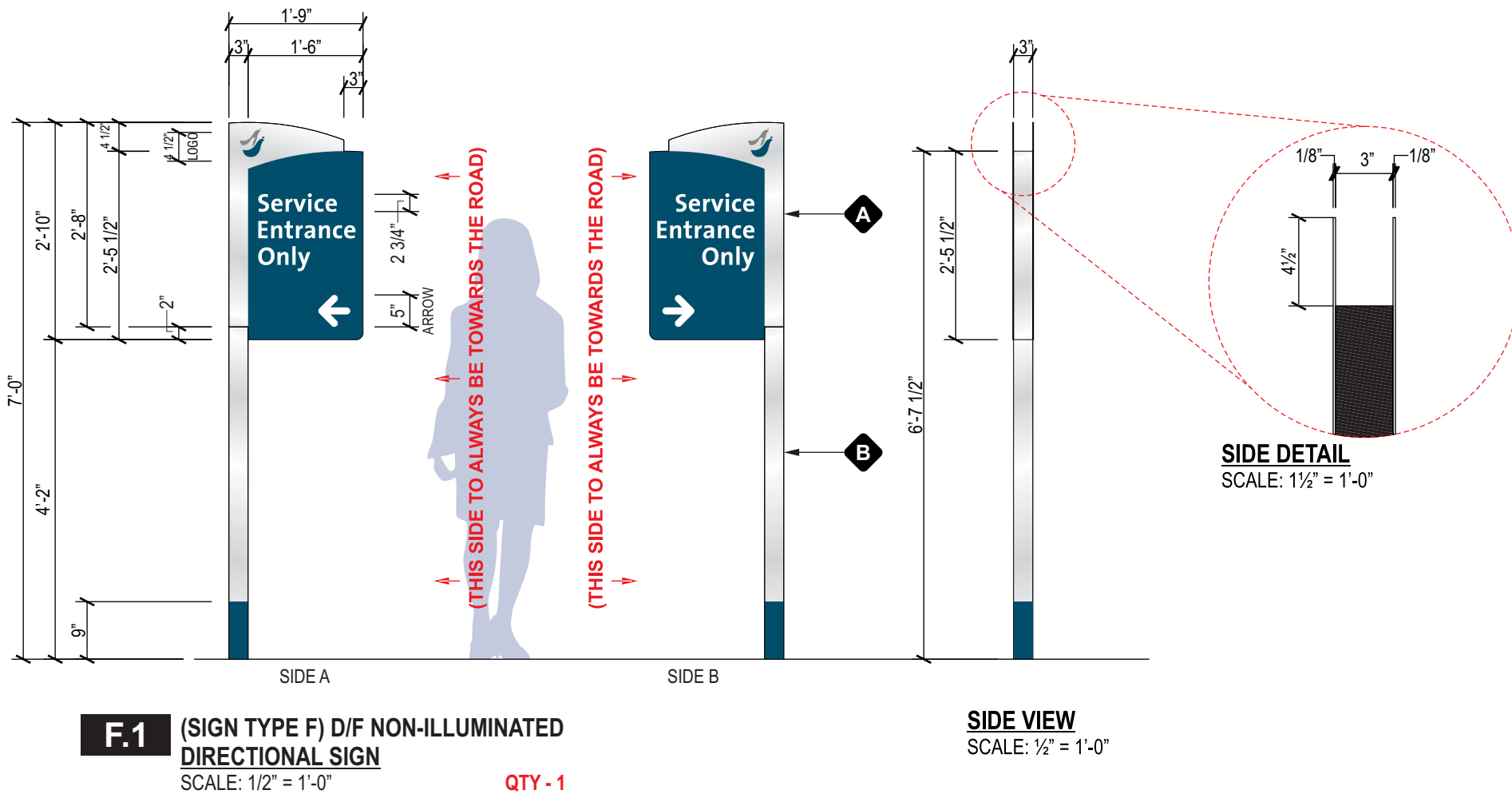

**PLAN VIEW**

SCALE: 3/8" = 1'-0"

**SIGN SPECIFICATIONS**



**SIGN FACE**

**FACE MATERIAL:** .125" THICK ALUMINUM OVER 3" ALUMINUM TUBE FRAME  
**FINISH:** PAINTED MATTHEWS BRUSHED ALUMINUM (SATIN) & TO MATCH PMS 3025C BLUE/GREEN (SATIN)  
**GRAPHIC SPECS:** 3M 680-10 REFLECTIVE WHITE VINYL COPY  
**LOGO FINISH:** PAINTED TO MATCH PMS 3025C BLUE/GREEN (SATIN) & MATTHEWS PAINT MP 28448 UMBRA GREY METALLIC LRV 31.5 (SATIN)  
**INSTALL METHOD:** FACES ARE CHEMICALLY WELDED TO ALUMINUM TUBE FRAME & MAIN SUPPORT.



**MAIN SUPPORTS**

**MATERIAL:** 3" X 3" ALUMINUM TUBE  
**FINISH:** PAINTED MATTHEWS BRUSHED ALUMINUM (SATIN) & TO MATCH PMS 3025C BLUE/GREEN (SATIN)  
**INSTALL METHOD:** DIRECT BURIAL INTO AN AUGURED HOLE FILLED WITH CONCRETE

**SIDE VIEW**

SCALE: 1/2" = 1'-0"

**SIDE DETAIL**

SCALE: 1 1/2" = 1'-0"

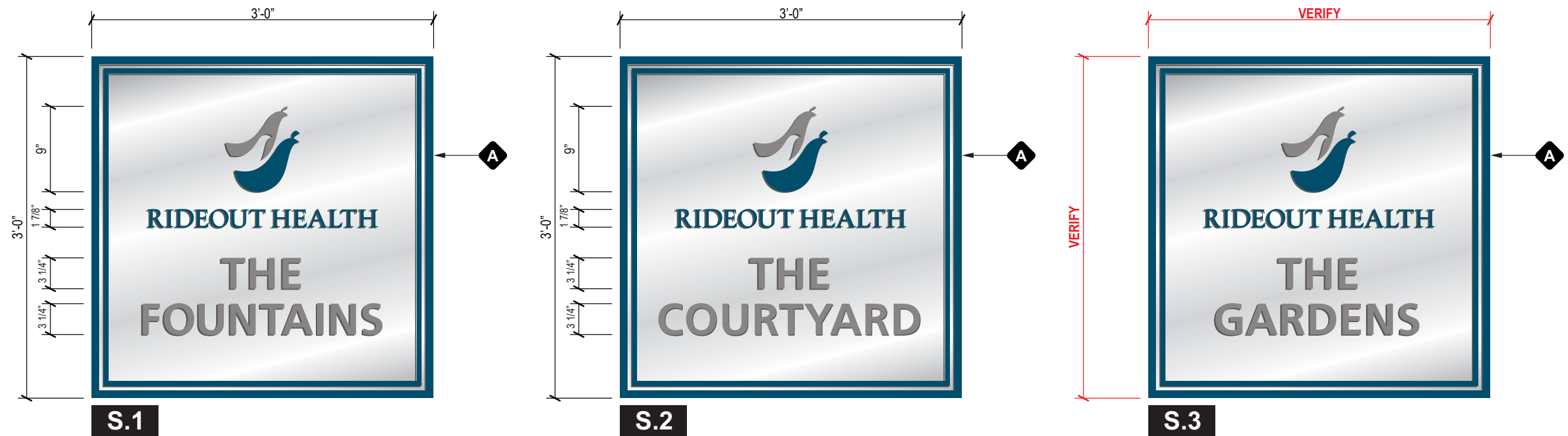

### SIGN SPECIFICATIONS

- A SIGN FACE**  
**MATERIAL:** 1/8" THK. CAST ALUMINUM PLAQUE  
**RECESSED BACKGROUND FINISH:** PAINTED MATTHEWS BRUSHED ALUMINUM (SATIN)  
**RAISED BORDER & GRAPHIC SPECS:** PAINTED TO MATCH PMS 3025C BLUE/GREEN (SATIN) & MATTHEWS PAINT MP 28448 UMBRA GREY METALLIC LRV 31.5 (SATIN)  
**INSTALL METHOD:** FLUSH MOUNT TO EXISTING WALL/COLUMN (**INSTALLATION METHOD SUBJECT TO FIELD VERIFICATION**)

**(SIGN TYPE S) S/F NON-ILLUMINATED WALL SIGN**

SCALE: 1" = 1'-0"

**QTY - 3**

**SEATTLE • SAN DIEGO**

**MAIN OFFICE**  
380 STEVENS AVENUE #307  
SOLANA BEACH, CA 92075

PHONE: 858.345.1542  
FAX: 858.408.3203

#### CLIENT INFORMATION:

**Fremont - Rideout Health Group**  
**Senior Living Campus**  
1240 - 1260 Williams Way  
Yuba City, CA 95991

#### APPROVALS:

IG ACCOUNT MANAGER \_\_\_\_\_

IG PRODUCTION MANAGER \_\_\_\_\_

CLIENT APPROVAL \_\_\_\_\_

#### SALES REP:

**Rebecca Redmon**

#### DESIGNER:

**R.Germar**

#### REVISION DATES:

**4 07-24-2013 RLG**

**5 08-08-2013 RLG**

**6 08-23-2013 RLG**

**7 09-10-2013 RLG**

**8 09-17-2013 RLG**

#### VOLTAGE:

**120V** ☐

**240V** ☐

THIS ORIGINAL UNPUBLISHED DESIGN IS THE SOLE PROPERTY OF IMAGE GROUP. IT CANNOT BE REPRODUCED, COPIED OR EXHIBITED IN WHOLE OR PART, WITHOUT FIRST OBTAINING WRITTEN CONSENT FROM IMAGE GROUP. COLORS REPRESENTED IN THIS DRAWING ARE FOR PRESENTATION PURPOSES ONLY. THEY MAY NOT MATCH YOUR FINISHED PRODUCT PERFECTLY. COLOR CALL-OUTS ARE FOR REFERENCE PURPOSES ONLY.

PRIMARY ELECTRICAL TO SIGN LOCATIONS IS TO BE PROVIDED BY OTHERS. 20 AMP DEDICATED CIRCUIT(S) WITH NO SHARED NEUTRALS AND A GROUND RETURNING TO THE PANEL IS REQUIRED FOR ALL INSTALLATIONS. THIS SIGN IS INTENDED TO BE INSTALLED IN ACCORDANCE WITH THE REQUIREMENTS OF ARTICLE 600 OF THE NATIONAL ELECTRICAL CODE AND/OR OTHER APPLICABLE LOCAL CODES. THIS INCLUDES PROPER GROUNDING AND BONDING OF THE SIGN.

#### DATE

**04-26-2013**

#### DESIGN NO:

**13-1071-08**

#### PROJECT LOCATION:

**Senior Living Campus**

#### SIGN TYPE:

**Sign Type S**  
**Wall Sign**